

P702/2F Wentworth Park Road Glebe NSW

2 1

This exceptional property perfectly combines modern living with a prime location, making it an ideal choice for those seeking both style and convenience in Glebe. This stunning apartment boasts breathtaking views overlooking Wentworth Park. Just a short stroll away, you'll find the vibrant Fish Markets, the bustling Broadway Shopping Centre, and the iconic Sydney CBD, making it a perfect spot for those who appreciate urban convenience.

+ Ducted air conditioning thoughtfully installed throughout the apartment.

+ Modern kitchen equipped with gas cooking facilities and a sleek dishwasher, making meal preparation a breeze.

[For full version visit the website](https://www.rogermickhail.com.au)

Type : Apartment
Price : \$950 pw
Land Size : 72 sqm
View : <https://www.rogermickhail.com.au/8172283>



Cesare Surace
02 9713 5900



Jessica Nakhle
02 9713 5900

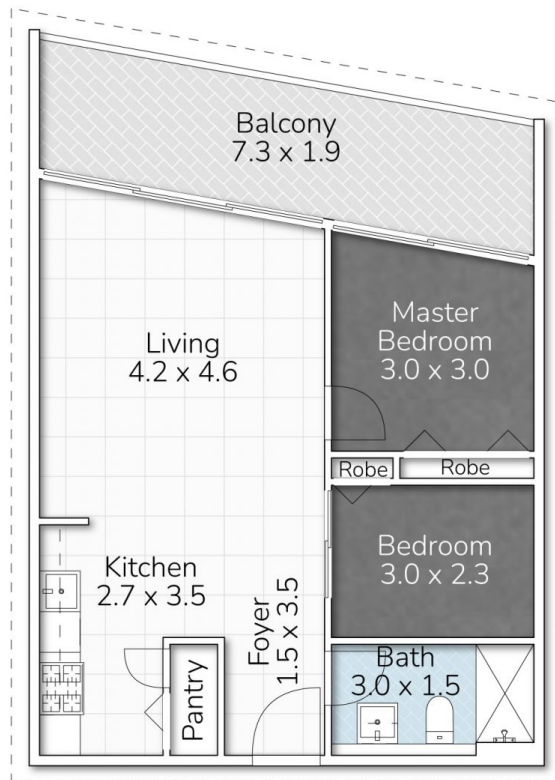

702/2F WENTWORTH PARK ROAD, GLEBE

 2 Bed
  1 Bath
  0 Car
 

Total 72m²

This floor plan is for marketing purposes only. Dimensions and layout are approximate. Mountfort Media gives no guarantee or warranty over the accuracy of this plan.